

Sizes  
30...50

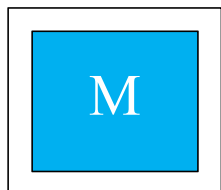

Weight  
3.6...16Kg

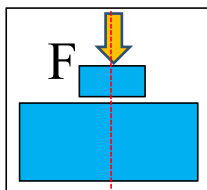

Axial Force  
1500...9000N

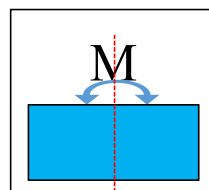

Torque  
10.6...49.5Nm

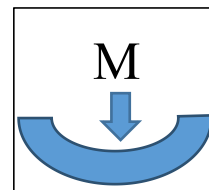

Bending moment  
30.8...340Nm

应用案例 / Application example



- ① SRH-P 30 旋转模块
- ② AZN 66 三爪定心夹爪

SRH-P 30 Swivel Head  
AZN 66 3-Jaw Concentric Gripper

## 旋转手腕 / Swivel head

### 原理

- 压缩空气推动两个齿条活塞做相反运动
- 齿条驱动齿轮轴转动
- 旋转角度 180°

### Principle

- Air pressure drives the piston racks in opposite directions
- the piston racks simultaneously drive the pinion gear which is attached to the flange
- Swivel angle 180°

## 剖视图 / Sectional diagram

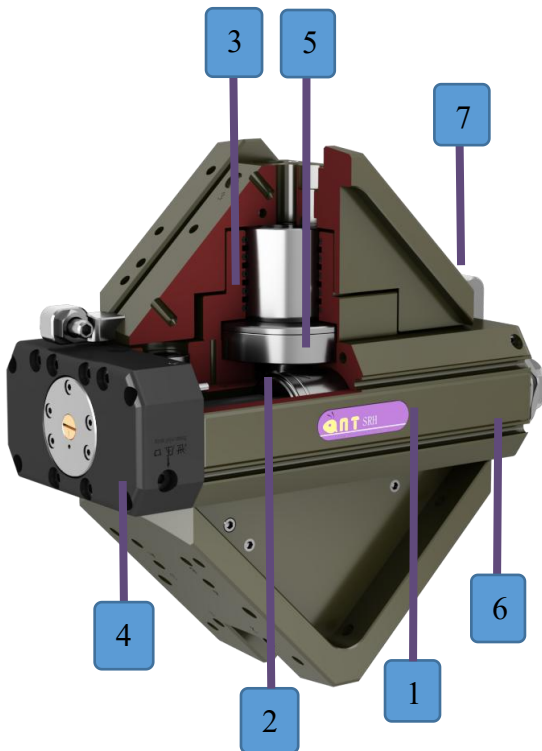

### 1 本体 Housing

涂层处理的高强度铝合金  
High-strength aluminum alloy, anodized

### 2 传动方式 Transmission Model

齿轮齿条传动方式  
Rotary actuator of rack & pinion type

### 3 内部走气 Hoss-free direct connction

无管线走气  
For hoseless tansfer of compressed air

### 4 缓冲模块 The buffer module

可调节的缓冲结构  
Adjustable cushion structure improves both performance and Accuracy

### 5 高精度轴承 High precision bearing

高负载，高精度  
High force and torque intake,high precision

### 6 磁性开关安装槽 Integrated slot

安装和定位磁性开关  
Mounting and positioning of magnetic field sensors

### 7 外置限位 External Stop

可调、方便、保护内部运动机构  
Adjustable、convenient、protect internal mechanism

## 传感系统 Sensor system

### 磁性开关 / Magnetic Sensor(选购/Order)



#### 型号(NO.)

NPN	WMS-M9N
PNP	WMS-M9P

- 传感器成对使用
- 磁性传感器不适用于连接具有磁性的连接板或环境为磁场环境和环境温度大于 80℃ 下使用
- Two sensors (NO contacts) are required for each swivel unit.
- The magnetic sensors are not suitable for connecting the magnetic plate or the environment is magnetic field and the temperature is greater than 80°C.

## SRH-P

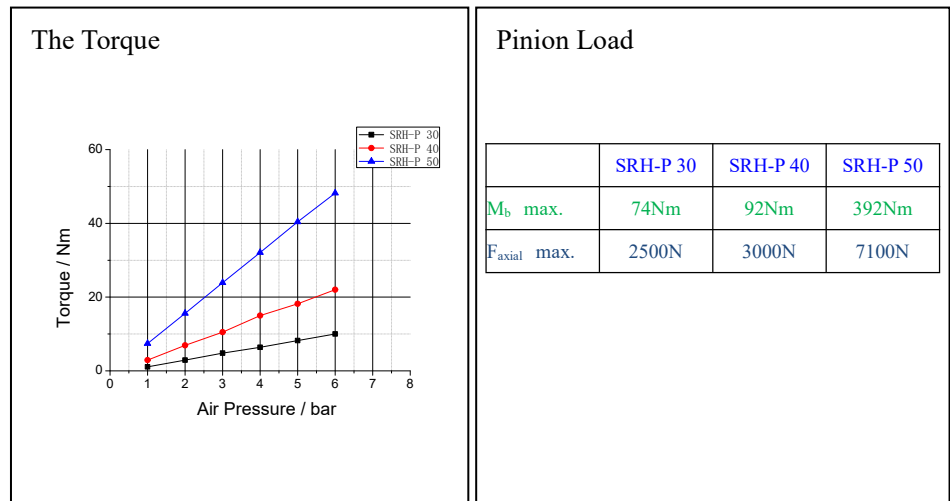

❖所有参数为气压 6bar 下测试/All data measured at 6bar

## 技术资料 Technical data

Description		SRH-P 30	SRH-P 30-E	SRH-P 40	SRH-P 40-E	SRH-P 50	SRH-P 50-E
扭矩 Torque	旋转扭矩 $T=k*P$ (k:系数, P:bar) [Nm]	1.76*P	1.76*P	3.76*P	3.76*P	8.25*P	8.25*P
	6bar 气压下旋转扭矩 [Nm]	10.5	10.5	22	22	49.5	49.5
旋转角度 Rotating angle	[°]			180			
调整角度 Adjustability of end positions	[°]			3.0			
直接连接口 No. of fluid feed-through		4	无	4	无	4	无
IP 等级 IP class				64			
自重 Self weight	[Kg]	4	3.9	7.5	7.3	15.8	15
旋转时间 Swiveling time with middle attached load	[s]	0.9	0.9	1.2	1.2	1.5	1.5
使用压力 Nominal pressure	[bar]			6			
最大使用压力 Maximum pressure	[bar]			8			
最小使用压力 Minimum pressure	[bar]			3			
空气消耗量 Air consumption per double stroke	[cm <sup>3</sup> ]	196	196	322	322	560	560
适应最小/最大环境温度 Min./max. ambient temperature	[°C]			5~60			
重复精度 Repeat accuracy	[°]	0.05	0.1	0.07	0.1	0.07	0.1
缓冲装置 Buffering mode		液压缓冲器/Hydraulic damper					

✧P: 空气压力[bar] \*重复精度: 连续动作 100 次后检测值

✧P: Pressure[bar] \*Repeat accuracy is defined as the spread of the limit position after 100 consecutive strokes

尺寸图/Dimensions

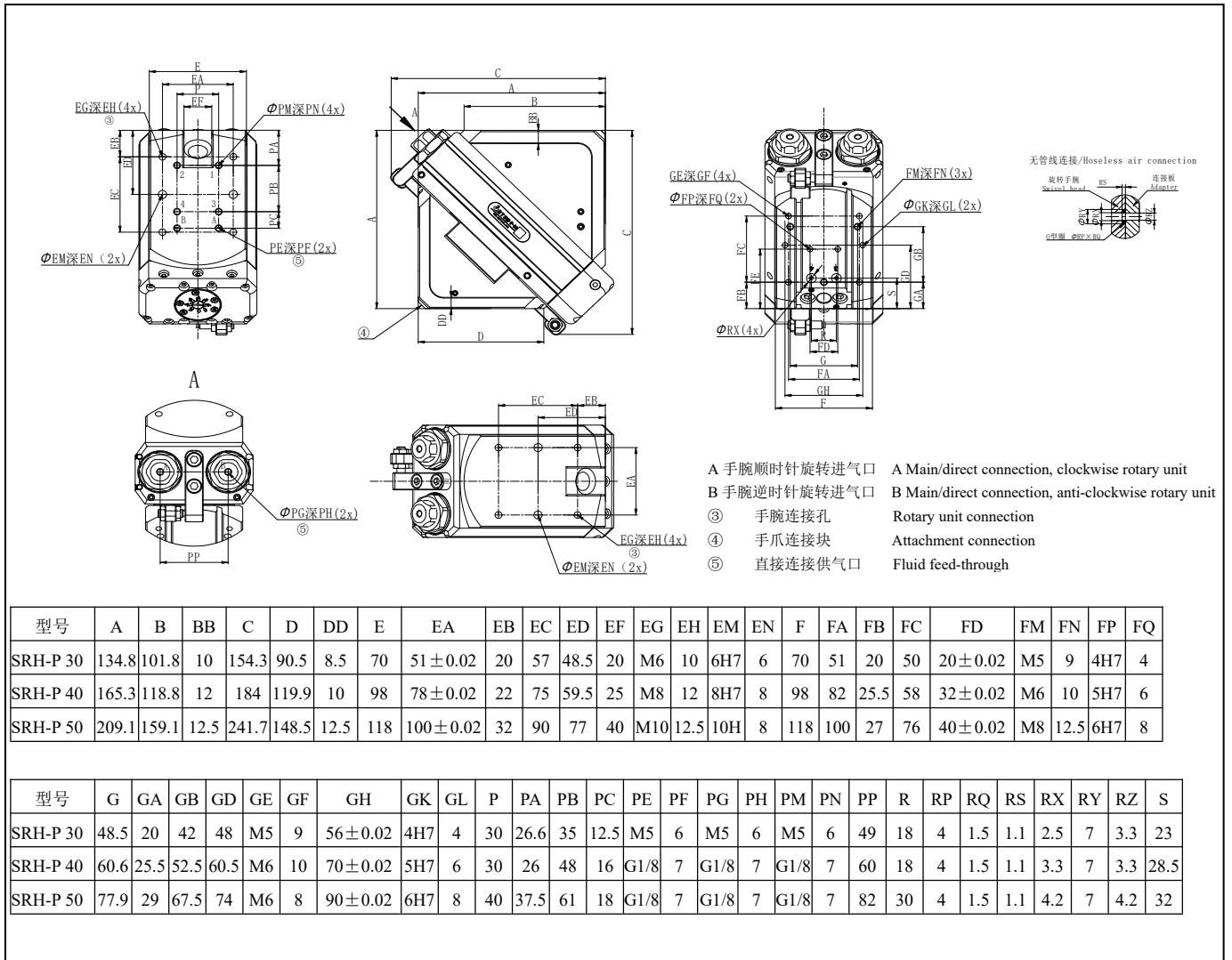

适配的手爪 / Adapter for gripper assembly

三爪

二爪

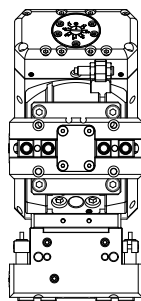
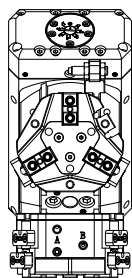

型号	三爪	二爪
SRH-P 30	AZN66/AZN80	AGN80/AGN100
SRH-P 40	AZN80/AZN100	AGN160
SRH-P 50	AZN100/AZN125	4AGN160

中心线孔 / Center Bore

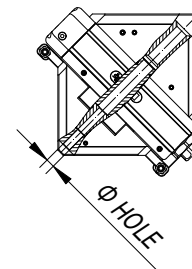

型号	中心孔 (Hole)
SRH-P 30	Φ10
SRH-P 30-E	Φ14
SRH-P 40	Φ14
SRH-P 40-E	Φ18
SRH-P 50	Φ20
SRH-P 50-E	Φ25